



**NATIONAL INSTITUTE OF PHARMACEUTICAL EDUCATION AND
RESEARCH (NIPER)**

**Sector 67, S.A.S. Nagar (Mohali)
Telephone No. 2214682-87, Fax No. 0172-2214692**

No. NIQ19/2017/IND14558/

Dated: 15.09.2017

NOTICE INVITING QUOTATION

We are interested in the purchase of the articles mentioned below, please send your quotation addressed to Director, NIPER, clearly specify in outer cover **“quotation for Providing and Fixing of Portable lab Furniture and date of opening of quotation”**. The quotation must be accompanied by a forwarding on letter pad of your company mentioning (I) Name of the material, (II) reference of this letter and (III) date of opening of Quotation. Your quotation should be deposited in Tender Box located at Ist Floor Administrative Bhawan, of NIPER on or before **06.10.2017** upto 3.00 p.m. to be opened on **06.10.2017** at 3:30 p.m. in the Conference Room on the first floor of Administrative Bhawan of NIPER in the presence of tenderers, whosoever may wish to be present.

Sr.No.	Description of Materials	Qty
1	Providing and fixing of Portable Lab Furniture for Instrument Lab Block C 305 as BOQ and Drawing	As per BOQ

Yours faithfully

Store Purchase Officer

INSTRUCTIONS

1. The firm should have PAN, GST registration with a valid TIN and proof of the same must be attached with the bid. Please submit your tenders if you are in a position to provide the requisite supplies in accordance with the requirements stated in the attached schedule. The firm should have technical competence, financial resources and reputation to make such supplies. **Each bidder must submit only one quotation.**
2. NIPER being a Research Institute best discount should be offered.
3. Payment of Bills will be made on receipt of material in good conditions, after satisfactory inspection. No advance payment will be made for purchase of any item. Payments will most likely be made within 30 days of the receipt of material good condition /inspection/Installation of equipment.
4. The Director, NIPER, Mohali reserves the right to accept or reject any tender or part thereof, without assigning any reasons. All disputes will be subject to the jurisdiction of S.A.S. Nagar (Mohali) only.
5. All the items mentioned in Supply order should be delivered in single lot only. No part supplies shall be accepted. Extension, if any, for supply of items is needed should be sought from the SPO, NIPER well in advance before the expiry of due date of Supply order with proper justifications.
6. The rates quoted should be inclusive of VAT / Excise, etc. In no case, rates should be quoted excluding VAT / Excise duty. Rates should be quoted in the enclosed proforma only. No separate quotations shall be entertained. Rates should be quoted neatly. There should be no overwriting / cutting. Cutting if any should be duly attested with dated signatures. The quality / make of items must also be indicated with the rates.
7. The institute shall not be responsible for any postal delays and quotations received after the stipulated date & time shall be summarily rejected. Quotations through FAX / E-Mail will not be entertained. And no communication will be send regarding the same.
8. If the tenderer does not accept the offer, after issue of letter of award by Institute within 15 days, the offer made shall be deemed to be withdrawn without any notice.
9. The schedules – I of the tender form should be returned intact duly filled up & signed. In the event of the space provided on the schedule – I form being insufficient for the required purpose, additional pages may be added. Each additional page must be attached with & referenced in the tender form.
10. The tenderer is at liberty to be present or to authorize a representative to be present at the time of opening of the tenders. The name and address of the representative who would be attending the opening of the tender on its behalf should be indicated in the tender.
11. The Institute is not bound to accept the lowest or any other tenders on specific grounds and also reserves the right of accepting the tenders in whole or in part. Tenders containing any other specific terms & conditions not agreed to by the institute may not be entertained.
12. The time for the date of delivery / dispatch stipulated in supply order shall be deemed to be the essence of the contract and if the supplier fails to deliver or dispatch any consignment within the period prescribed for such delivery or dispatch in the supply order, liquidated damages may be deducted from the bill @ 0.5% per week subject to maximum of 10% of the value of the delayed goods or services

under the contract after which supply order shall be cancelled. The Competent Authority of the institute may also cancel the supply at the cost & liability of the supplier. In such a case, security deposit of the supplier shall stand forfeited. Further, items should be delivered strictly as per their make / specification mentioned in the Supply Order, in case the quality of goods supplied are not in conformity with the standard given in tender or the supplies are found defective at any stage these goods shall immediately be taken back by the supplier and will be replaced with the tender quality goods, without any delay. The Competent Authority reserves all rights to reject the goods if the same are not found in accordance with the required description / specifications and liquidates damages shall be charged in addition to the cost of re- tender.

13. Conditional offers shall be straightway rejected. The Contractor shall not sub-let the contract. Any information furnished by the bidder found incorrect at any later stage, shall make the agency liable to be debarred from future tendering / taking up the works in NIPER. The department reserves the right to verify the particulars furnished by the bidders independently.
14. The contract shall be governed by the laws and procedures established by the GoI, within the framework of applicable legislation and enactment made from time to time concerning such Commercial dealings / processing.
15. There shall be no change in price structure during the currency of contract except of the statutory levies which are made applicable by the Govt. through notifications / regulations.
16. While submitting the price list in foreign currency, the supplier must submit the price list of principal company or the price list submitted by supplier must have the endorsement of Principal Company.
17. NIPER, Mohali also reserves the right to test the chemicals & solvents for their quality if it so desired.
18. The items, so supplied will have to be of high quality and grade and in the inspection/test if these are found to be of inferior quality, the same are to be replaced by supplier at their cost within the stipulated period, failing which the Rate contract of the firm may be cancelled. Delayed supply / non-compliance of complete order may also lead to the cancellation of contract.
19. The Chemicals/ Solvents supplied should be of latest batch only with maximum shelf life.
20. Price should be for delivery at NIPER, Sector-67, Mohali. The freight, Insurance charges, if any will not be borne by this institute. Similarly shortage, pilferage in transit etc shall be sole responsibility of the supplier and the same will be intimated to the supplier on receipt of goods by the purchaser to make good the loss caused on this account. The defective supply will have to be replaced by the supplier within 7 days without any freight / transport/ other charges.
21. This institute is exempted from payment of Custom Duty & Central Excise Duty (Non-Industrial – R&D Institute). Bidders are therefore asked to quote the rates accordingly.
22. The tenders are liable to be rejected if above conditions are not complied with.
23. **If you are on D.G.S. & D. rate contract, please quote D.G.S& D rate & rate contract number enclosing a copy thereof.**

Signatures of the Bidder(s)
With Stamp

Schedule I

BOQ

P/F of Portable Lab furnitures for Instrument Lab

Location : Block C-305, NIPER, S.A.S Nagar.

S. No	Description of Item	Qty	Unit	Rate	Amount
1	P/F Lab table granite top made of : Frame: MS square pipe 32x32x2.5 mm thick duly arc welded ,grounded and powder coated 150 micron thick . height adjustment of table frame with nut&bolt system with dia 2" base plate . frame size 5'9"x2'5"X2'3" PVC Sheet: The sheet shall be 19mm thick to be laid on top of the frame as a cushion to the Granite slab. it is to be fixed with 2" steel screws from below side. Size 5'9"x2'5" Granite Slab : The slab to be 18mm thick telephone black shade duly cut to size & moulded on all sides including polished and fixing with adhesives (Araldite)on top of table All the details as required shall as per similar sample available at Niper. Details of design as per drawing enclosed.				
	Size 5'9"x 2'6"x2'6"(LxBxH)	3	Nos		
2	P/F of storage cabinet made from MS sheet 20 Guage thick duly powder coated 150 micron dual shade having povision of smooth sliding noisless channels 50mm for drawer and 4" hinges 4 nos. for cabinets, SS handles 3nos. and locks 2nos and properly fitted with lab table as per sample etc .Details as per drawing enclosed .				
	size 2'3"x2'x2'(LXBxD)	2	nos		
				Total	
				Tax @ _____	
				Tax @ _____	
				G.Total	

Terms & Conditions :-

1. Rates should include shifting and installation of lab furniture at 3rd level of site.
 2. Taxes as applicable should be clearly mentioned.
 3. Any other works, if applicable shall be extra.
 4. Acceptable makes of material
MS Pipe/Sheet - Tata /jindal/ Rathi.
PVC sheet board - Eco plus /alsthom
 5. Completion time - 01 month from the date of award of order.
 6. Payment Terms :- 80% against delivery at site. 10% against installation and 10% against commissioning/testing.
 7. The work shall have to be completed with respect to quality and workmanship to the satisfaction of Engineer-in-Charge, NIPER.
 8. The Director, NIPER shall be the final authority in all matter of financial, work completion, administrative related to the said work.
- I Accept all the Terms & Conditions, as applicable.

Signature of Tenderer with stamp

LAYOUT OF LAB FURNITURE IN INSTRUMENT

LOCATION:- C-305

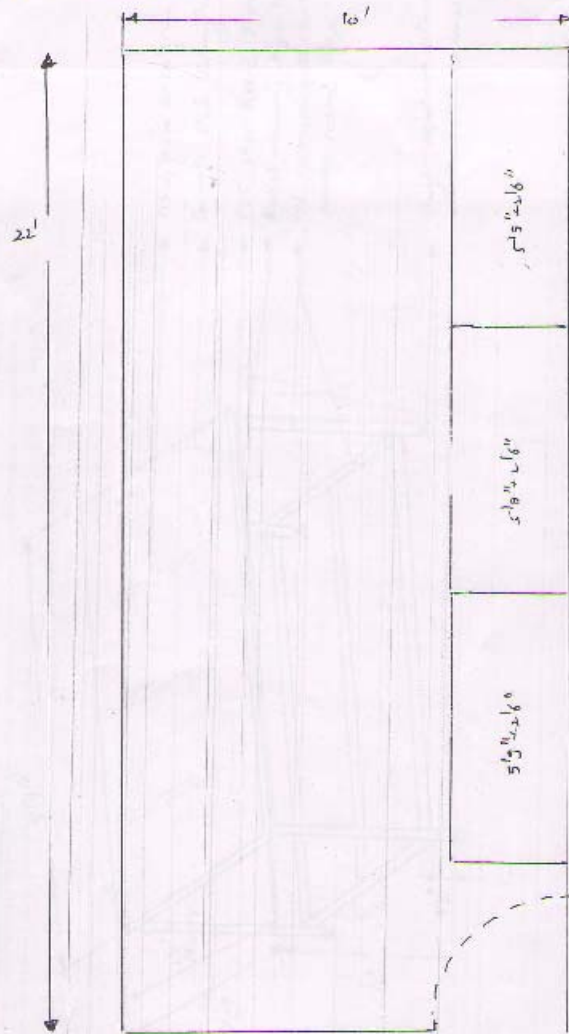

LAB STORAGE CABINET. EXP. LAB TABLE

g: Not to scale

Note: Any dimension reqd. may be taken from office

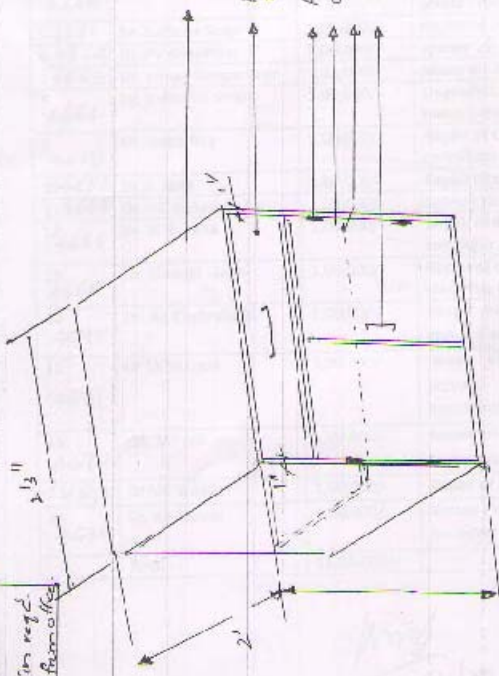

MS sheet 20 Ga. powder coated 150A.

Drawer sliding on channel - 2nd. for smooth movement.

Hinges 3/4" size.

Cabinet doors shelf portable 18" depth.

Cabinet Handle

LAB TABLE FOR LAB C-305

Drwg: Not to scale.

Note: Any clarification required may be taken from office.

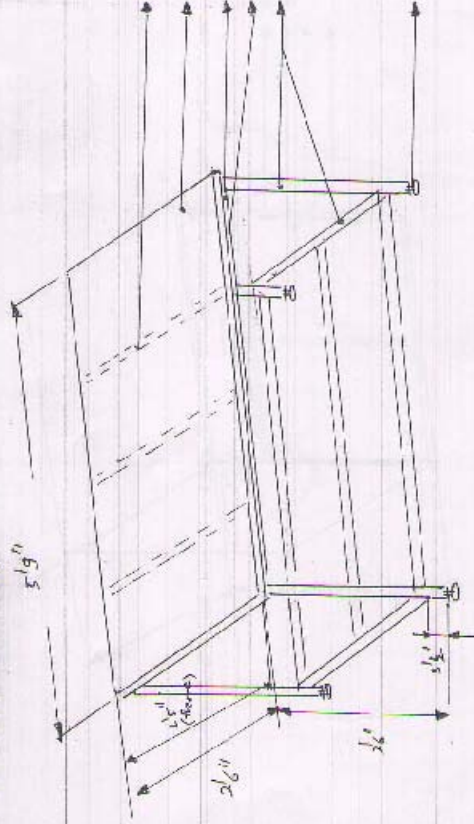

MS sq pipes 32x32x2.5mm supports.

Granite slab 18mm Thick.

PVC Sheet Board 19mm Thick 5'9" x 3'6"

Basical masonry w/ granite slab only.

MS square pipe 22x30x2.5mm Thick

powder coated 150µ

Height adjustment 150mm adjustability system with basic plate - 6mm

